

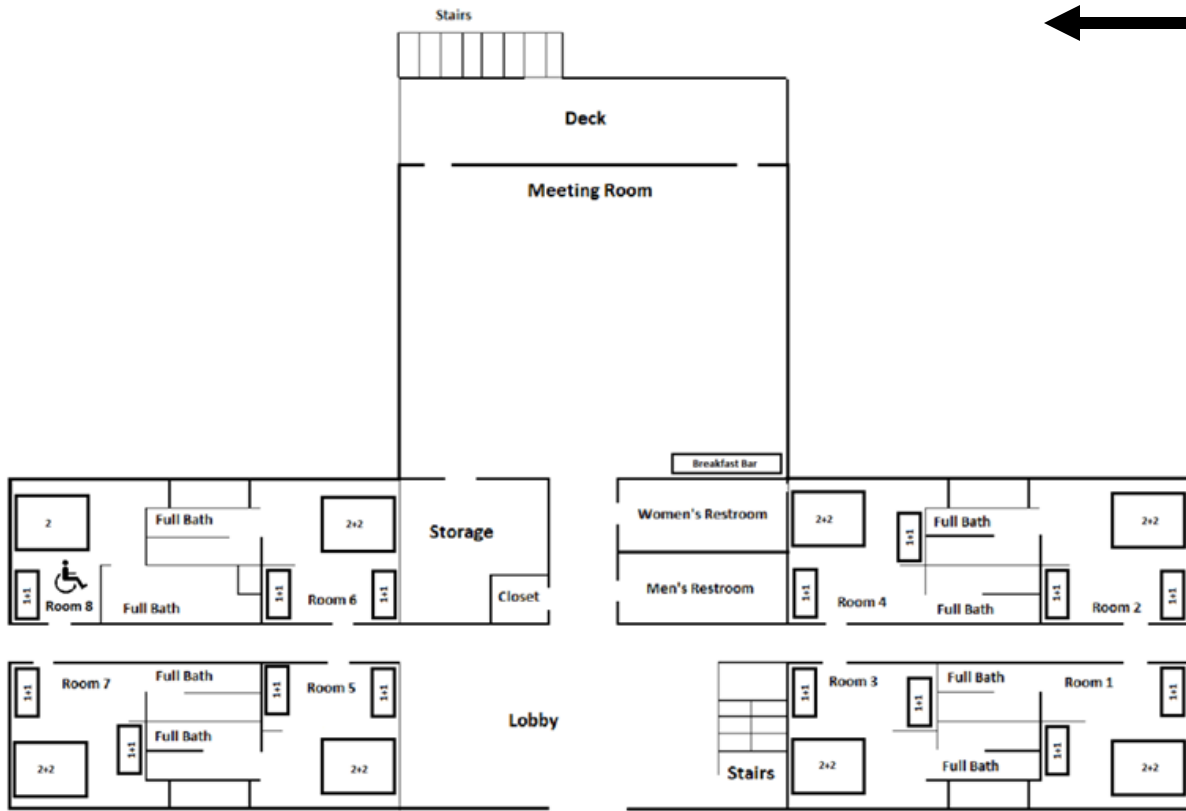

**MAP KEY:**

- ① OAKVIEW LODGE
- ② PINE VIEW LODGE
- ③ POOL BATH HOUSE
- ④ CHAPEL
- ⑤ OUTDOOR CHAPEL
- ⑥ PHILS HOUSE
- ⑦ MILLHOUSE
- ⑧ CRAFT BARN
- ⑨ SPRUCE CENTER GYM
- ① LIONS DEN
- ② ANT HILL
- ③ BEE HIVE
- ④ CHIPMUCK BURROW
- ⑤ EAGLES NEST
- ⑥ SQUIRRELS NEST
- ⑦ BEAVER DAM
- ⑧ BEAR CAVE
- ⑨ SHOWER HOUSE
- ① ZIPLINE
- ② CLIMBING TOWER
- ③ GIANT SWING
- ④ GA-GA COURT
- ⑤ BOULDERING BARN
- ⑥ BALLFIELD, BASKETBALL, VOLLEYBALL
- ⑦ CAMPFIRE
- ⑧ WOODS
- ⑨ GRASS
- ① TREE
- TRAIL / WALKWAY / DRIVE WAY



**Oak View Upstairs:**

Sleeps 60

Each room has:

- A restroom and shower
- Heat and A/C control

Rooms 1-7:

- 2 queen beds (bunk)
- 4 single beds (bunk)

Room 8: Handicap Accessible

- 1 queen bed
- 2 single beds (bunk)

Lobby with gas fire place

Public restrooms

Meeting Room: seats 150

- 12 Channel Sound
- 4- 6 mics
- XLR cables
- DVD Player
- Mounted Video Projector
- VGA hook up, front & back
- Podium
- 4 DI Boxes

**Oak View Downstairs:**

Sleeps 30

Each room has:

- A restroom and shower
- Heat and A/C control

Rooms 11-13:

- 2 queen beds (bunk)
- 4 single beds (bunk)

Room 14: Handicap Accessible

- 2 queen beds (bunk)
- 2 single beds (bunk)

Open lounge area

Public restrooms

Meeting Room: seats 250

- 2 channel sound
- 1-2 mics
- XLR cables
- Podium
- 8x8 stage 12" tall

Kitchen:

- Commercial stove, frig & dishwasher
- Ice Maker & Freezer
- Plates, Cups & Utensils
- Serving Dishes
- Cooking pans, kettles, etc.





**Pine View Downstairs:**

Sleeps 38

Rooms 1:

- 1 queen bed
- Private shower & restroom

Rooms 2-5:

- 1 double
- 7 single beds (bunk)
- Public Restrooms & Showers
- Lounge Area with wood fireplace

Meeting Room:

- Seats 100
- 4 Channel Sound
- 4 mics
- XLR cables

**Pine View Upstairs:**

Kitchen:

- Walk In Frig, Freezer
- Reach In Frig
- Commercial Stove, Griddle,
- Dishwasher
- Ice Maker
- Plates, Cups & Utensils
- Serving Dishes
- Kettles, Pans
- Main Dining Room with wood fire-  
place (200)
- Public Restrooms
- Camp Office

**Millhouse:**

**First Floor:**

Kitchen:

- Commercial Stove
- Fridge, Freezer
- Dishwasher
- Serving Dishes
- Kettles, Pans
- Plates, Cups & Utensils
- Dining Area (60)
- Lounge Area with wood fire-  
place

**Second Floor:**

Sleeps 28

Rooms 1:

- 5 Single beds (bunk)
- 1 double bed

Rooms 2:

- 1 double bed
- 3 single beds (bunk)

Room 3:

- 6 single beds (bunk)

Room 4:

- 2 double beds (bunk)
- 2 single beds (bunk)
- Private Restroom & Shower

Room 5: (third floor)

- 1 double bed, 3 single beds
- Public Restrooms & Showers



## **Additional Meeting Areas:**

### **Chapel:**

Seats 150  
4 - 6 Channel Sound  
2 - 3 mics  
XLR Cables  
Video Projector  
VGA Hook Up Front & Back  
DVD Player

### **Craft Barn:**

Portable Sound Available  
Seats 70

### **Spruce Center Gym:**

Meeting Room:  
Seats 50  
Breakfast Bar with Frig  
Portable Sound Available  
Gym:  
70' x 100'  
Volleyballs, Basketballs, Playground Balls  
Game Room Loft:  
Ping Pong, Pool Tables, Air Hockey, Foos Ball, Sofas  
Public Restrooms

### **Portable Sound:**

2 Channel Sound  
2 Mics  
XLR Cables

### **Outdoor Fire Rings:**

Millhouse Ring: Picnic tables, small ring  
Pine View Ring (Outdoor Chapel): Large ring, Amphitheater style benches  
Oak View Ring: Large Ring, Log Benches

## **Additional Lodging Areas:**

### **Cabins:**

#### **Lions Den:**

Sleeps 10  
Gas Heat  
Private Restroom & Shower

#### **Ant Hill:**

Sleep 8  
Gas Heat

#### **Bee Hive:**

Sleeps 8  
Gas Heat

#### **Chipmunk:**

Sleeps 8  
Gas Heat

#### **Eagles Nest:**

Sleep 10  
Gas Heat

#### **Squirrels Nest:**

Sleep 16 (2 rooms)  
Gas Heat

#### **Beaver Dam:**

Sleeps 10  
Gas Heat

#### **Bear Cave:**

Sleeps 10  
Gas Heat

### **Shower House for Cabins:**

Restrooms & Showers

### **Pool Bath House:** Open Memorial Day to Labor Day

\*winters upon request  
Restrooms & Showers (located by chapel)

## **Things to Do:**

**Pool:** 25' x 60' Memorial Day - Labor Day  
**Zip Line, Climbing Tower, Giant Swing, Low Ropes, Recreation Field (volleyball, basketball, kick ball field), Hiking Trails, Wading Creek, Gaga Court**